

OWNER'S CERTIFICATE

This is to certify that the undersigned, Sun Mesa LLC is the owner of the tract of land represented on this plat, and has consented to the preparation and recordation of this plat and that the same is executed in compliance with and subject to the provisions of N.R.S. Chapter 116 and 278, and the streets, avenues and highways and all appurtenances thereto as shown are hereby dedicated and set apart to be used as public thoroughfares forever, and hereby grants to all public utilities and Washoe County permanent easements shown on this plat for plowed snow storage, the construction and maintenance of traffic control signage, drainage and utility systems, together with the right of access thereto forever, dedicates to Washoe County Parcel B as shown on the plat; and hereby grants to Washoe County temporary right-of-way for roadway turnarounds shown hereon. The owner and assignees agree to the use of residential water meters.

SUN MESA LLC
A Nevada Limited Liability Company

[Signature]
JAMES F. BAWDEN
MEMBER

4/26/05
DATE

NOTARY'S CERTIFICATE

STATE OF NEVADA }
COUNTY OF WASHOE } SS

This instrument was acknowledged before me on APRIL 26, 2005, by James F. Bawden as Member of Sun Mesa LLC, a Nevada Limited Liability Company.

[Signature]
NOTARY PUBLIC

My commission expires on 3/3/08



SECURITY INTEREST HOLDER'S CERTIFICATE

This is to certify that the undersigned, Bank of America, N.A. consents to the preparation and recordation of this plat.

BANK OF AMERICA, N.A.

[Signature]
RICHARD A. SOLENBAKER
VICE PRESIDENT

4/27/05
DATE

NOTARY'S CERTIFICATE

STATE OF NEVADA }
COUNTY OF WASHOE } SS

This instrument was acknowledged before me on APRIL 27, 2005 by Richard A. Solenbaker as Vice President of Bank of America, N.A.

[Signature]
NOTARY PUBLIC

My commission expires on 12-31-07



UTILITY COMPANIES' CERTIFICATE

The utility easements shown on this plat have been checked, accepted and approved by the undersigned utility and cable television companies.

[Signature]
SIERRA PACIFIC POWER COMPANY CAROLYN CAMEA

6/2/2005
DATE

[Signature]
NEVADA BELL TELEPHONE COMPANY
6/6/05 SEC. NEVADA

4/26/05
DATE

[Signature]
CHARTER COMMUNICATIONS, ELIAS RUIZ

4-26-05
DATE

[Signature]
DARRIN PRICE
SUN VALLEY GID

9-15-05
DATE

TAX CERTIFICATE

The undersigned hereby certifies that all property taxes on this land for the fiscal year have been paid and that the full amount of any deferred property taxes for the conversion of the property from agricultural use has been paid pursuant to NRS 361A.205.

WASHOE COUNTY-TREASURER

[Signature]
BY

DEPUTY TREASURER

9/8/2005
DATE

SUN MESA - PHASE 1

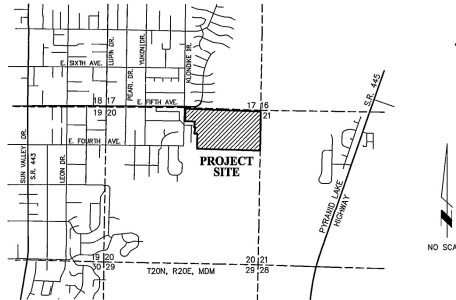

VICINITY MAP

SURVEYOR'S CERTIFICATE

I, Mark D. Morberg, a Professional Land Surveyor licensed in the State of Nevada, certify that:

1. This plat represents the results of a survey conducted under my direct supervision at the instance of Sun Mesa LLC.
2. The lands surveyed lie within the NE 1/4 of Section 20, T20N, R20E, MDM, and the survey was completed on 11/28/04.
3. This plat complies with the applicable state statutes and any local ordinances in effect on the date that the governing body gave its final approval.
4. The monuments depicted on the plat will be of the character shown and occupy the positions indicated by monuments 22, 23, 24, and an appropriate financial guarantee will be posted with the governing body before recordation to ensure the installation of the monuments.

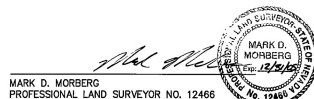

COUNTY SURVEYOR'S CERTIFICATE

I hereby certify that I have examined this map consisting of 4 sheets and that I am satisfied that said map is technically correct and that an adequate performance guarantee has been filed guaranteeing the monuments as shown will be set by 11/28/04.



JACK M. HOLMES, WASHOE COUNTY SURVEYOR
PROFESSIONAL LAND SURVEYOR NO. 9611

DISTRICT BOARD OF HEALTH CERTIFICATE

This final map is approved by the Washoe County District Board of Health. This approval concerns sewage disposal, water pollution, water supply and water supply facilities and is predicated upon plans for a public water supply and a community system for disposal of sewage.

[Signature]
FOR THE DISTRICT BOARD OF HEALTH

9/28/05
DATE

DIVISION OF WATER RESOURCES CERTIFICATE

This plat is approved by the State of Nevada Division of Water Resources of the Department of Conservation and Natural Resources concerning water quantity subject to the review of approval on file in this office.

[Signature]
DIVISION OF WATER RESOURCES

9/16/2005
DATE

WATER RIGHT DEDICATION CERTIFICATE

The water and sewer resource requirements set forth in Article 422 of the Washoe County Development Code, related to the dedication of water resources have been satisfied.

[Signature]
WASHOE COUNTY
DEPARTMENT OF WATER RESOURCES

9/29/05
DATE

TITLE COMPANY CERTIFICATE

The undersigned hereby certifies that this plat has been examined and that Sun Mesa LLC owns of record an interest in the lands delineated hereon, and that it is the only owner of record of said land; that all the owners of record of the land have signed the final map; that Bank of America, N.A. holds of record a security interest in the land to be divided; and that there are no liens of record against the land delineated hereon for delinquent state, county, municipal, federal or local taxes or assessments collected as taxes or special assessments, and that a guarantee dated 11/28/04 for the benefit of the County of Washoe, State of Nevada, has been issued with regard to all of the above.

[Signature]
FIRST AMERICAN TITLE INSURANCE COMPANY

9-7-06
12-7-05
4-26-05
DATE

[Signature]
RON BREAZALE
TITLE OFFICER

DIRECTOR OF COMMUNITY DEVELOPMENT CERTIFICATE

The tentative map for Sun Mesa, TM04-001, was approved by the Washoe County Planning Commission on the 20th day of April, 2004.

This final map for Sun Mesa - Phase 1 meets all applicable statutes, ordinances and code provisions; is in substantial conformance with the tentative map and all conditions have been met.

The next final map for TM04-001 must be approved and accepted for recordation by the Community Development Director on or before the expiration date, the 31st day of March, 2007, or on extension of time for the tentative map must be approved by the Washoe County Planning Commission on or before said date.

This final map for Sun Mesa - Phase 1 is approved and accepted for recordation this 31st day of MARCH, 2006 by the Washoe County Community Development Director. The offer of dedication for roadway is rejected at this time, but will remain open in accordance with NRS Chapter 278. *and Parcel B

[Signature]
ADRIAN D. FREEMAN
DIRECTOR OF COMMUNITY DEVELOPMENT

03/03/06
DATE

FILE NO. <u>3360640</u> FEE: <u>64.00</u> FILED FOR RECORD AT THE REQUEST OF <u>Sun Mesa LLC</u> ON THIS <u>14th</u> DAY OF <u>MARCH</u> 2006 AT <u>1:15</u> MINUTES PAST <u>9</u> O'CLOCK A.M., OFFICIAL RECORDS OF WASHOE COUNTY, NEVADA. COUNTY RECORDER BY: <u>C. Parthen</u> DEPUTY	OFFICIAL PLAT OF SUN MESA - PHASE 1 FOR NE 1/4 SECTION 20, T20N, R20E, MDM WASHOE COUNTY, NEVADA Stantec Consulting 6900 Sierra Center Parkway Suite 100 Reno, Nevada 89511 Tel: (775) 850-0777 Fax: (775) 850-0787 stantec.com	JOB NO. 180100782 DESIGNED MDM DRAWN AutoCad COMP. CHECKED DATE JAN 24, 2005 NO SHEET 1 OF 4 SHEETS
------------------------------------------------------------------------------------------------------------------------------------------------------------------------------------------------------------------------------------------------------------------------------------------------------------	--------------------------------------------------------------------------------------------------------------------------------------------------------------------------------------------------------------------------------------------------------------------------	-----------------------------------------------------------------------------------------------------------------------

AMERICAN SURVEYING & MAPPING COMPANY, INC.
10000 W. 10th St., Suite 100
Reno, NV 89511
Tel: (775) 850-0777
Fax: (775) 850-0787
www.american-surveying.com

3360640

Subdivision Tract Map 4618

4618
SHOULD BE EXAMINED
FOR ANY DISCREPANCIES
CHANGES TO THIS MAP